

Office of Teaching, Learning & Technology

Gathering Student Feedback

Academic Technologies

Spring 2021

Tips For This Training

- This training is being recorded.
- Please mute yourself when not talking.
- Use the chat any time.
- Need more help? Contact the ITS Help Desk.
 - Email: its-helpdesk@uiowa.edu
 - Phone: (319)384-HELP(4357)

Training Agenda

- Part 1: Synchronous Feedback Tools with Zoom
 - Reactions and Nonverbals, Chat, Polls, Annotations
- Part 2: Asynchronous Feedback Tools in ICON
 - Discussions, Quizzes
- Part 3: Other Survey Tools
 - Top Hat, Qualtrics, ACE Surveys

Importance of student feedback

- Gather information about how students are learning
- Gauge student attitudes
- Adjust teaching based on data

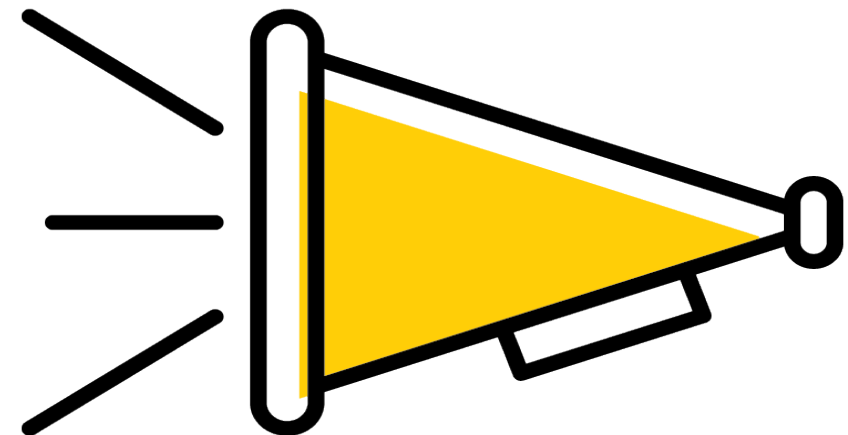

Part 1

Synchronous Feedback Tools with Zoom

Reactions in Zoom

- A quick way to get student feedback.
- Reactions show up in Gallery View and Participants.
- Participants shows how many participants have a reaction.

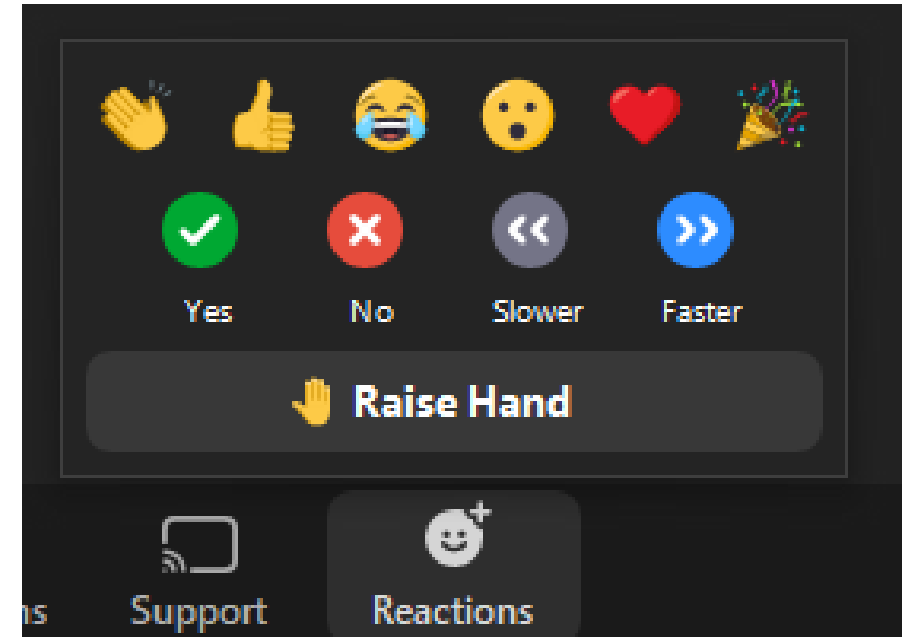

Chat Options

- A way all students can participate.
- Set guidelines for how to use chat in your class.
- TAs or students can watch chat during lecture.
- Save chats using ... or autosave all chats in settings at uiowa.zoom.us.

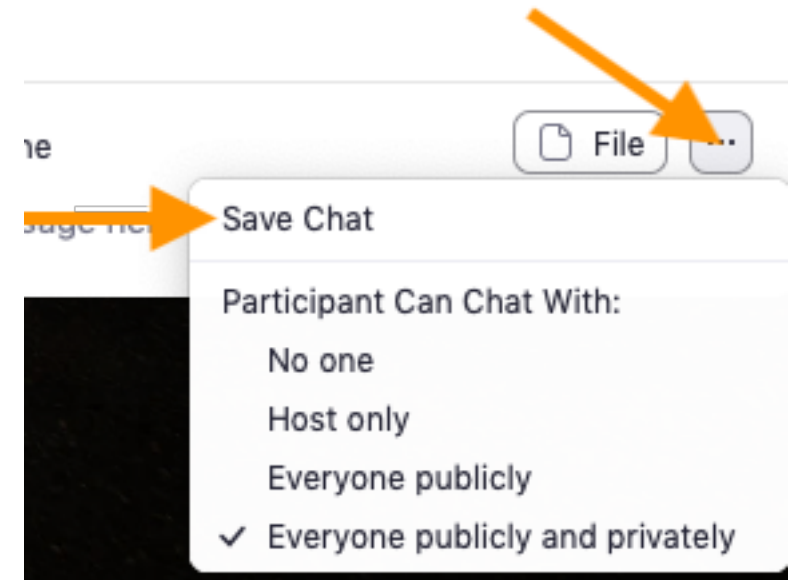



Polls

- Only the creator of the Zoom session can create polls.
- All hosts and cohosts can activate poll questions.
- Polls available in reoccurring Zoom sessions.
- Can access poll reports up to a month later.
- No ICON gradebook connection.

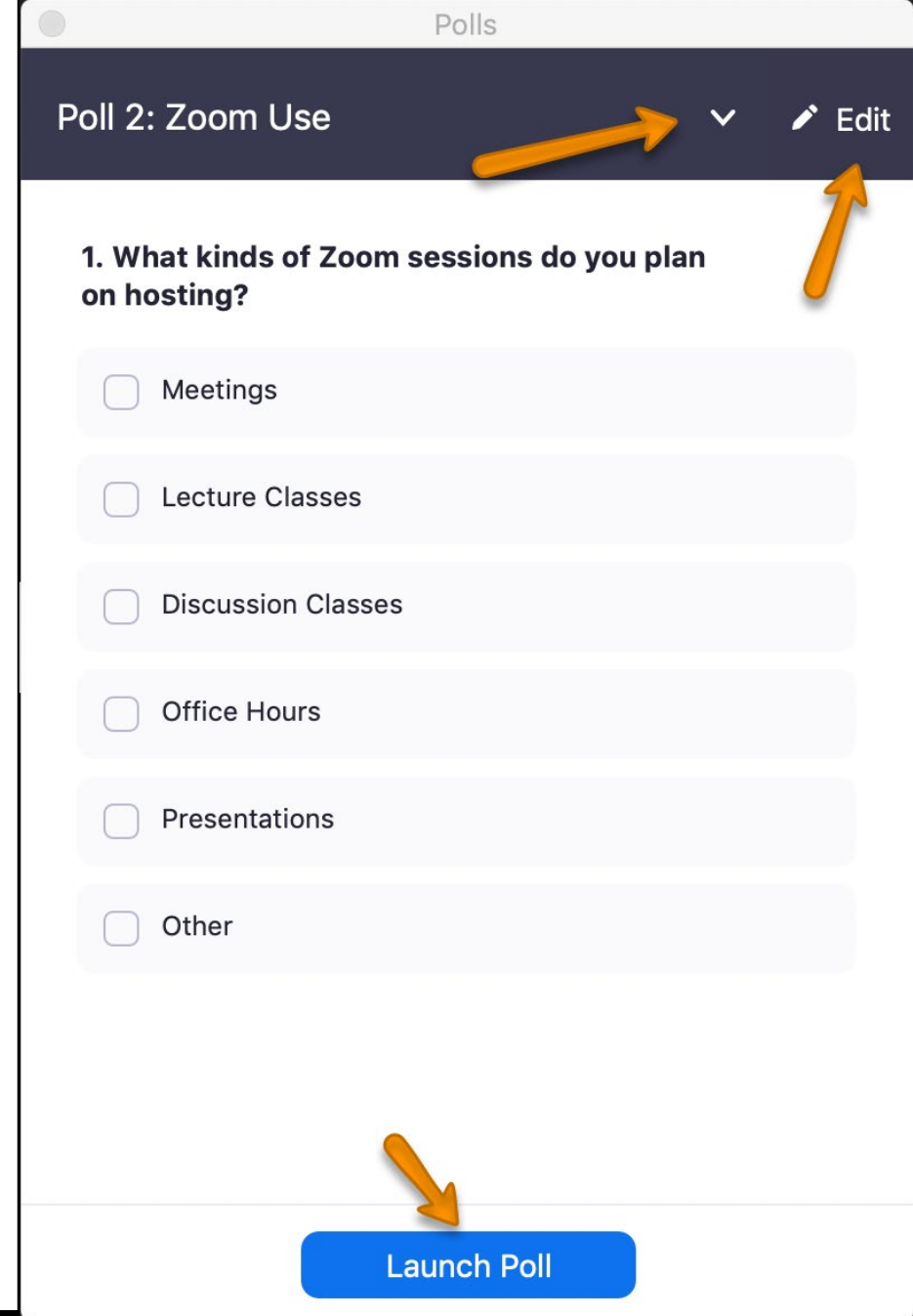

Annotations

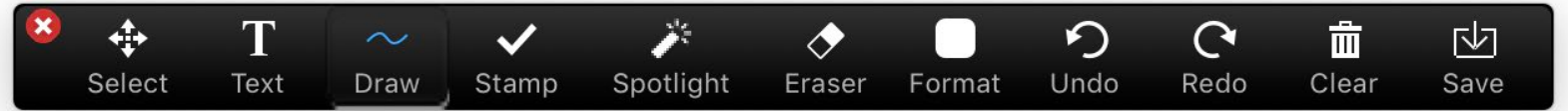

- Quick check on mood or learning.
- Can allow annotations during screenshare.
- Anyone can save screenshot of annotations.

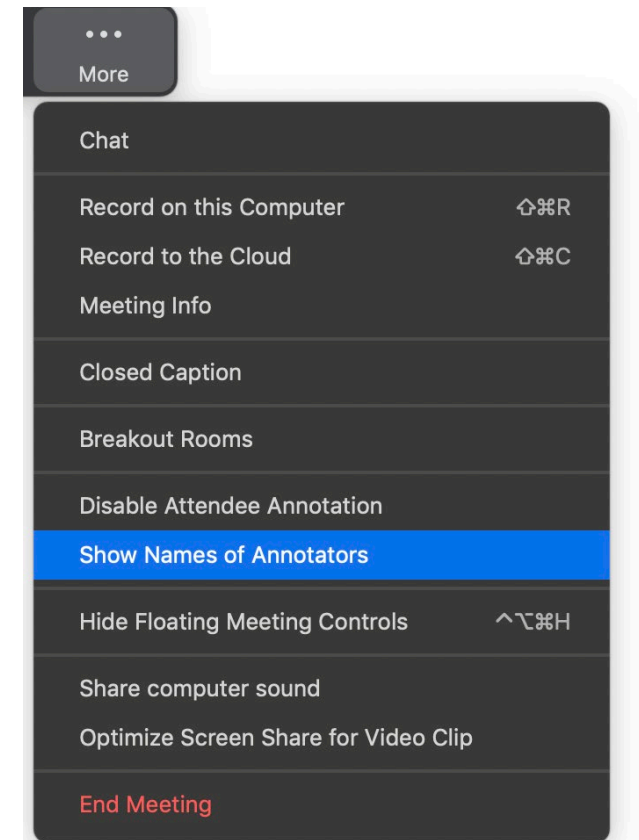

On a 1-9 rubber duck scale, how are things going today?

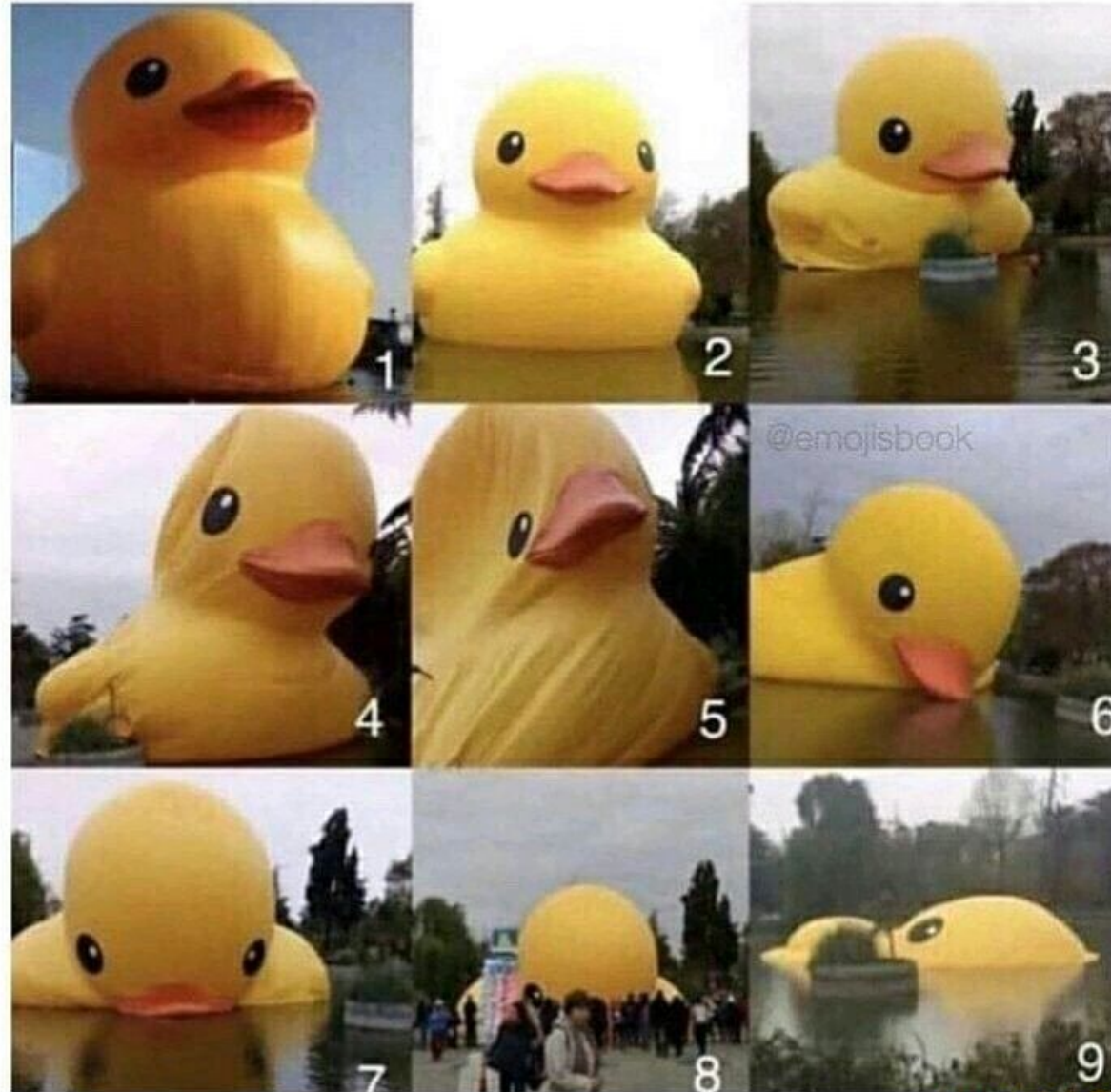

Part 2

Asynchronous Feedback Tools in ICON

ICON Discussions

- Ungraded discussions good for ongoing questions.
- Graded discussions can be used to check student understanding.
- Set expectations for when instructors will respond to questions and comments.

Published Edit ⋮

 **Muddiest points**
[Holly Soboroff](#) Oct 4 at 2:28pm 2 3
[All Sections](#)

Share your muddiest points from this week's readings. These are the most difficult or confusing points in the reading. Your answers should be a sentence or two long.

Unread 👁 ↑ ↓ Subscribed

[← Reply](#)

 [Walter Jessup](#)
2:31pm ⋮

Lorem ipsum dolor sit amet, consectetur adipiscing elit. Fusce et lectus sit amet quam laoreet aliquam. Ut iaculis justo mauris, vitae imperdiet libero ullamcorper nec. Orci varius natoque penatibus et magnis dis parturient montes, nascetur ridiculus mus.

 [Tommy](#)
2:33pm ⋮

Mauris ultricies urna sed felis feugiat accumsan.

[← Reply](#)

ICON Quizzes to Collect Feedback

→ Ungraded quizzes in ICON can be used as surveys to gather feedback.

Feedback Survey

Started: Oct 4 at 2:10pm

Quiz Instructions

This is an ungraded survey, but I would appreciate it if you took a few minutes to fill this out.



Question 1

1 pts

What study strategies are working well for you in this course?

[HTML Editor](#)

B *I* U A **A** *I* x^2 x_2 12pt Paragraph

Part 3

Other Survey Tools



Top Hat

- Upload slides to add questions and present.
- Basic: Free for students, includes interactive presentation options, no ICON gradebook connection.
- Pro: \$20 per semester, \$55 lifetime. Includes online presentations, ICON connection, and asynchronous homework and review options.

What strategies are you using in class?

- A** Taking notes over readings.
- B** Taking notes over recorded lectures.
- C** Study group.
- D** Other

Qualtrics

Instructors at Iowa have additional options for collecting student feedback

- Can be anonymous
- Has powerful branching options
- Many different question types
- No ICON gradebook connection

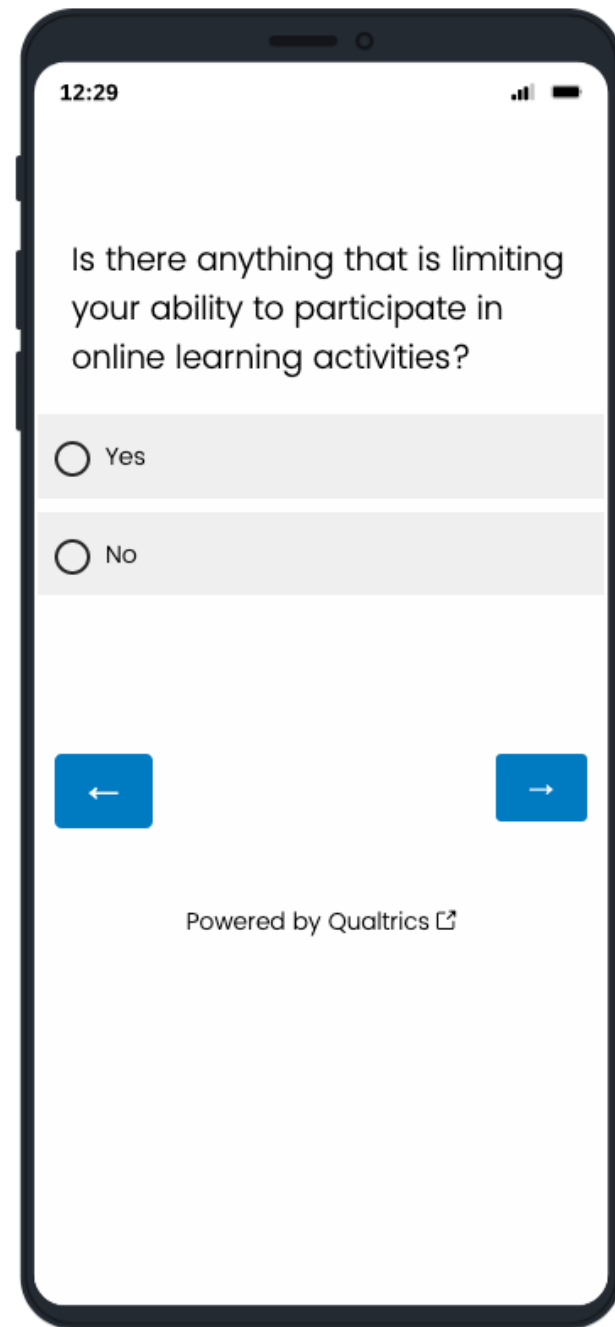

ACE evaluation surveys

- Completely anonymous
- Not limited to specific questions.
- Gets students familiar with the ACE platform prior to the end of the semester
- No ICON gradebook connection

Survey

← My Surveys

Student Feedback

Edit Access Distribute Invite Results

Settings

Page 1

Part 1

How helpful are the recorded lectures?

Extremely helpful
Helpful
Somewhat helpful
Only a little helpful
Not helpful at all

Part 2

Please explain why the recorded lectures are helpful or less helpful

Add Category

Need Help?

- [Request a consultation](#), with follow-up support as needed, to discuss course structure, communication strategies, course facilitation, and more.
- Ask a SITA for Technical Consultations
 - SITA@uiowa.edu
 - <https://tinyurl.com/bookasita>
- [Contact the ITS Help Desk](#) for technical troubleshooting or technology issues/questions.

Resources

- Distance and Online Education
 - <https://distance.uiowa.edu/>
- Office of Teaching Learning and Technology
 - <https://teach.its.uiowa.edu/>
 - <https://teach.uiowa.edu/all-technology-tools>
- ITS Help Desk
 - Email: its-helpdesk@uiowa.edu
 - Phone: (319)384-HELP(4357)

IOWA